

## ADDENDUM NO. 1

TO: PLANS AND SPECIFICATIONS FOR STATE OF MISSOURI

Roof Replacement  
Kirksville Regional Office  
Kirksville, Missouri  
PROJECT NO.: M1706-01

***Bid Opening Date: 1:30 PM, Thursday, July 12, 2018 (Not Changed)***

**Bidders are hereby informed that the construction Plans and/or Specifications are modified as follows:**

### **GENERAL COMMENTS:**

1. The Pre-Bid meeting was held June 26, 2018 followed by a walk-through of the project site.
2. Bidders needing additional site inspection should contact Larry Jackson at 660-785-2342 to schedule a time.
3. Submit design questions to Mike Sundermeyer, [Mike.Sundermeyer@cascoCorp.com](mailto:Mike.Sundermeyer@cascoCorp.com), and copy Scott Zeller, [Scott.Zeller@oa.mo.gov](mailto:Scott.Zeller@oa.mo.gov).
4. Please contact Kelly Copeland, Contract Specialist or Marlene Blackburn at 573-522-2283 or 573-522-6035, [Kelly.Copeland@oa.mo.gov](mailto:Kelly.Copeland@oa.mo.gov) or [Marlene.Blackburn@oa.mo.gov](mailto:Marlene.Blackburn@oa.mo.gov) for questions about bidding procedures and MBE\WBE\SDVE Goals and submittal requirements.
5. Current Planholders list available on line at:  
[http://planroom.adsmo.net/viewJobs.asp?action=view&job\\_id=6697](http://planroom.adsmo.net/viewJobs.asp?action=view&job_id=6697)
6. Prospective Bidders contact American Document Solutions, 1400 Forum Blvd Suite 1C, Columbia MO 65201, 573-446-7768 to order official plans and specifications.

### **SPECIFICATION CHANGES:**

1. Section 074113.16 – STANDING-SEAM METAL ROOF PANELS, 2.2. STANDING-SEAM METAL ROOF PANELS, Paragraph A., subsection 2: **DELETE** the following in its entirety:
  2. ***Aluminum Panel Systems: Unless more stringent requirements are indicated, comply with ASTM E 1637.***
2. Section 074113.16 – STANDING-SEAM METAL ROOF PANELS, 2.2 STANDING-SEAM METAL ROOF PANELS, Paragraph B, subsection 1: **DELETE** subsection “1” and replace as follows:
  1. ***Basis-of-Design Product: Subject to compliance with the requirements of these specifications, provide Berridge Manufacturing Company; Double-Lock Zee-Lock (180 Degree Seam) or comparable product by one of the following:***
    - a. ***MBCI Double-Lok***
    - b. ***American Building Components LokSeam***
    - c. ***Dimensional Metals, Inc.Double-Lock***
    - d. ***Englert, Series 2500 Panel System***

- e. **Petersen Aluminum, Tite-Loc Plus**
  - f. **Butler, MR-24 Roof System**
  - g. **Behlen ZL-16**
  - h. **Union Corrugating Company, ML200**
  - i. **Or equal and approved by Architect prior to bid completion**
3. Section 074113.16 – STANDING-SEAM METAL ROOF PANELS, 2.2 STANDING-SEAM METAL ROOF PANELS, Paragraph B, subsection 2: **DELETE** subsection “2” and replace as follows:
- 2. **Prefinished metal shall be Aluminum-Zinc Alloy Coated (galvalume) Steel Sheet, 24-Gauge or 22-Gauge, ASTM 792-08, Grade 40, yield strength 40 ksi min.**
    - A. **Finish shall be full strength fluoropolymer coating applied by the manufacturer on a continuous coil coating line, with a top side dry film thickness of  $0.75 \pm 0.05$  mil over  $0.20 \pm 0.05$  mil prime coat, to provide a total top side dry film thickness of  $0.95 \pm 0.10$  mil. Bottom side shall be coated with a primer (non-metallics only) and beige urethane coating with a total dry film thickness of  $0.35 \pm 0.05$  mil. Finish shall conform to all tests for adhesion, flexibility, and longevity as specified by the finish supplier.**
    - B. **Strippable film shall be applied to the top side of all prefinished metal to protect the finish during fabrication, shipping and field handling. This strippable film MUST be removed immediately before installation.**
    - C. **Unpainted metal shall be Aluminum-Zinc Alloy Coated (galvalume) Steel Sheet, 24-Gauge or 22-Gauge, ASTM 792-08, Grade 40, yield strength 40 ksi min., with clear acrylic coating on both sides of material.**
    - D. **Field protection must be provided by the contractor at the job site so stacked or coiled material is not exposed to weather and moisture.**
    - E. **Flashing may be factory fabricated or field fabricated. Unless otherwise specified all exposed adjacent flashing shall be of the same material and finish as panel system.**
    - F. **Color as selected by Architect from manufacturer’s standard range.**
4. Section 074113.16 – STANDING-SEAM METAL ROOF PANELS, 2.4 MISCELLANEOUS MATERIALS, Paragraph G: **DELETE** paragraph G and replace as follows:
- G. **Panel Fasteners: Galvanized steel or stainless steel.**
5. Section 077253 – SNOW GUARDS, 2.2 SNOW GUARDS, Paragraph A: **Add** the following to the end of paragraph A:
- 4. **S5! Metal Roof Innovations, Ltd., ColorGard  
8750 Walker Road, 571-215-8276  
Colorado Springs, CO 80908**

**DRAWING CHANGES:**

- 1. Drawing A-503; ROOF DETAILS
  - a. **ADD** Detail 5-Downspout Tie-In To Storm on attached Supplemental Sketch SK-1. Replace existing clay pipe from downspout to storm cleanout with 4” PVC pipe.

2. Drawing A-101; ROOF PLAN

a. **ADD** General Note No. 10 as follows:

***10. Relocate, if required for manufacturer's warranty, any plumbing vents through attic and above deck in order to locate piping in the center of the roof panel. Maintain clear distance requirements from valleys, crickets, ridges, etc... per manufacturer's warranty requirements. Plumbing piping shall be PVC. Reference pipe penetration detail 5 on sheet A-501. Owner will provide access as needed inside the building and to the attic for contractor's coordination during construction. For locations where multiple pipes are spaced closely together, the general contractor may utilize a manufacturer approved square curb with sloped flat top. After construction of the square curb, apply rubberized boot flashing at base of pipe penetration similar to detail 5 on sheet A-501.***

**ATTACHMENTS:**

1. Pre-Bid Sign-In Sheet
2. Supplemental drawing SK-1

June 28, 2018

**END ADDENDUM NO. 1**

**Pre-Bid Meeting Attendance Sheet  
 Project Kirksville Regional Office Roof Replacement  
 Kirksville Regional Office  
 Kirksville, Missouri**

**Project No. M1706-01  
 10:30 AM, June 26, 2018**

Name & Title	Company Name Type of Contracting	MBE/WBE/ SDVE Status	Phone	E-Mail Address
<b>Scott Zeller</b> <b>Project Manager</b> 	OA-FMDC	-	573-751-2668	<a href="mailto:Scott.Zeller@oa.mo.gov">Scott.Zeller@oa.mo.gov</a>
<del><b>Larry Block</b></del> <del><b>Deputy Director-</b></del> <del><b>Operations</b></del>	OA-FMDC	-	573-526-6270	<a href="mailto:Larry.Block@oa.mo.gov">Larry.Block@oa.mo.gov</a>
<b>Mike</b> <b>Sundermeyer</b> <b>A/E Rep</b> 	CASCO	-	314-821-1100 573-645-9967	<a href="mailto:Mike.Sundermeyer@casco.com">Mike.Sundermeyer@casco.com</a>
<b>Kelly Copeland</b> <b>Contract</b> <b>Specialist</b>	OA-FMDC	-	573-522-2283	<a href="mailto:Kelly.Copeland@oa.mo.gov">Kelly.Copeland@oa.mo.gov</a>
<b>Larry Jackson</b> <b>OA-FMDC</b> <b>facility rep</b> 	OA-FMDC	-	660-785-2342	<a href="mailto:Larry.Jackson@oa.mo.gov">Larry.Jackson@oa.mo.gov</a>
<b>Carl Haley,</b> <b>Construction</b> <b>Administrator</b> 	OA-FMDC	-	573-526-0473	<a href="mailto:Carl.Haley@oa.mo.gov">Carl.Haley@oa.mo.gov</a>

**Pre-Bid Meeting Attendance Sheet**  
**Project Kirksville Regional Office Roof Replacement**  
**Kirksville Regional Office**  
**Kirksville, Missouri**

**Project No. M1706-01**  
**10:30 AM, June 26, 2018**

Name & Title	Company Name Type of Contracting	MBE/WBE/ SDVE Status	Phone	E-Mail Address
Bryan Chinn	OA-FMDC	NA	573- 751-2440	bryan.chinn@oa.mo.gov
Carle Rogers Salesman	Betty Foster Roofing	WBE	<del>402-218-</del> <del>7-78</del> 602-622-9277	Carle@bettyfosterroofing.com
Stephen Hirsch	OA-FMDC	NA	573-921-1032	Stephen.hirsch@oa.mo.gov
Steve Dams Pros	AVCO Inc.	N/A	816-465-0016	avcodahms@hotmail.com
Carl Haley	OA/FMDC	N/A	573-645-7834	Carl.Haley@oa.mo.gov
Brandon Dorge	OA/FMDC	NA	573-469-8825	Brandon.Dorge@OA.mo.gov



**Pre-Bid Meeting Attendance Sheet**  
**Project Kirksville Regional Office Roof Replacement**  
**Kirksville Regional Office**  
**Kirksville, Missouri**

Project No. M1706-01  
 10:30 AM, June 26, 2018

Name & Title	Company Name Type of Contracting	MBE/WBE/ SDVE Status	Phone	E-Mail Address
Cv / Daily	Watkins Roofing	NO	573-444-2951	Cv1d@watkinsroofing.net
BRUCE BEAULIEU SUPERINTENDENT	JRT CO. ROOFING		816-284-3693	bforce@srcousa.com
Sean Wallace Sales	A-level Roof Systems		620 <del>3308</del> 704 0873	Swallace@centurionind.com
JAMES WIEBERG PROJECT MANAGER	VERSLUES CONST. CO., INC	WBE	573-395-4323	jameswieberg@versluesconstruction.com
Kevin Phillips Owner	Full Service Roofing	NA	217-242-3628	Kevin@fullserviceroofing.com
Bob Sorenson Estimator	Full Service Roofing	N/A	(217) 430-2959	bob@fullserviceroofing.com

**Pre-Bid Meeting Attendance Sheet**  
**Project Kirksville Regional Office Roof Replacement**  
**Kirksville Regional Office**  
**Kirksville, Missouri**

**Project No. M1706-01**  
**10:30 AM, June 26, 2018**

Name & Title	Company Name Type of Contracting	MBE/WBE/ SDVE Status	Phone	E-Mail Address
Blake Botts PM	Division 7 Inc Roofing	WBE	660-826- 7741	blake@div7inc.com
Scott Washburn Rep	Triad Inc		660-654-2160	swashburn@triadfirst.com
MARLENE BLACKBURN	FMDC		573 522-6035	marlene.blackburn @ca.mo.gov
<del>AMP</del> Stacey Byrne	AMP Restoration & Construction LLC		314-581- 6600	sbyrne@theampco.com

**SCOPE OF WORK:**

- EXCAVATE DAMAGED PIPE AND DISCONNECT FROM DOWNSPOUT AND CLEAN-OUT.
- HAUL OFF AND DISPOSE OF MATERIALS (EXCEPT FOR SOIL) OFF-SITE TO AN APPROVED FACILITY.
- PREPARE DOWNSPOUT AND CLEAN-OUT FOR NEW UNDERGROUND PIPE CONNECTION.
- INSTALL NEW 4" PVC UNDERGROUND CONNECTION AND ATTACH TO DOWNSPOUT AND CLEAN-OUT.
- PROVIDE GRAVEL FOR PROPER PIPE BASE.
- PROVIDE NEW CONNECTION BOOT TO DOWNSPOUT AS REQUIRED.
- PROVIDE SEALED CONNECTION TO CLEAN-OUT (AS REQUIRED) TO CREATE A CLOSED SYSTEM.
- PROVIDE PROPER MIN. DRAINAGE 1/4" PER FOOT.
- BACKFILL TRENCH IN LIFTS OF NO MORE THAN 8" AND WATER SOIL TO PROVIDE SETTLEMENT. REPEAT PROCESS UNTIL TRENCH IS PROPERLY FILLED AND LEVEL WITH SURROUNDING GRADE.
- INSTALL NEW SOD TO MATCH ADJACENT TYPE AND WATER THOROUGHLY UPON COMPLETION.

STATE OF MISSOURI  
ERIC R. GRETTENS,  
GOVERNOR



**CASCO**

10877 WATSON ROAD  
ST. LOUIS, MO 63127  
ARCHITECTS / ENGINEERS  
314-821-1100

CASCO Diversified Corporation  
Certificate of Authority #000228 Arch.  
Certificate of Authority #000013 Eng.  
Exp. Date: 12/31/18

OFFICE OF  
ADMINISTRATION  
DIVISION OF FACILITIES  
MANAGEMENT,  
DESIGN AND  
CONSTRUCTION

DEPARTMENT OF  
MENTAL HEALTH

ROOF  
REPLACEMENT

KIRKSVILLE REGIONAL OFFICE

1702 EAST LAHARPE STREET  
KIRKSVILLE, MISSOURI

PROJECT # M1706-01  
SITE # 3620  
FACILITY # 47570

REVISION: \_\_\_\_\_  
DATE: \_\_\_\_\_  
REVISION: \_\_\_\_\_  
DATE: \_\_\_\_\_  
REVISION: \_\_\_\_\_  
DATE: \_\_\_\_\_

ISSUE DATE: 06/28/2018

CAD DWG FILE: M1706-01 SK-1  
DRAWN BY: MAM  
CHECKED BY: MSS  
DESIGNED BY: MSS

SHEET TITLE:

SUPPLEMENTAL  
SKETCH

SHEET NUMBER:

**SK-1**

1 OF 1 SHEETS  
06/28/2018

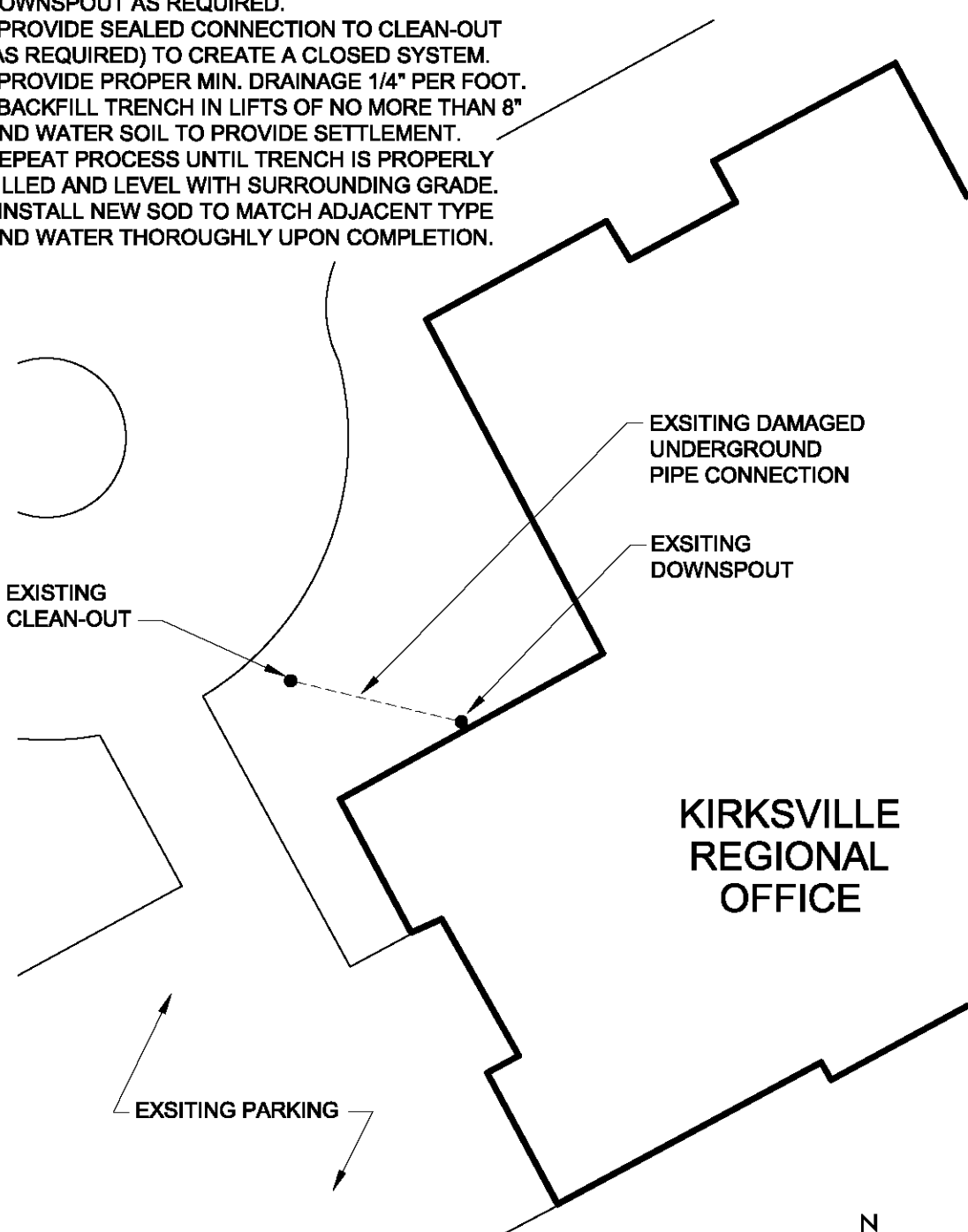

5  
A-503

**DOWNSPOUT TIE-IN TO STORM**  
SCALE: N.T.S.

