

ASBESTOS ABATEMENT GENERAL NOTES

1. ASBESTOS ABATEMENT SCOPE OF WORK IN HU-3 SPACES INCLUDES THE FOLLOWING:
1. ABATEMENT OF PLUMBING CHASES AT INDICATED AREAS.
2. ABATEMENT OF INMATE CELLS CONTAINING ROOF INSULATION.
2. DEPARTMENT OF CORRECTIONS (DOC) MAINTENANCE PERSONNEL TO RE-INSULATE PIPING.
3. CONTRACTOR TO ABATE ASBESTOS INSULATION IN THE FOLLOWING CELLS,
CELL NO'S: 694, 700, 706, 752, 758, 764, 837, 843, 864, 931, 937.
4. ALL ACM PIPE INSULATION IN DESIGNATED AREAS OF THIS SHEET TO BE ABATED USING THE GLOVE BAG METHOD.

ASBESTOS ABATEMENT SPECIFIC NOTES

5. ASBESTOS INSULATION ABATEMENT REQUIRED AT ROOF DRAINS LOCATED IN INMATE CELL ON UPPER LEVEL.
6. ASBESTOS INSULATION AND ASSOCIATED DEBRIS ABATEMENT REQUIRED AT ELBOWS IN PLUMBING CHASE ON BOTH LEVELS. CHASES EXTEND FROM CRAWLSPACE TO ROOF. ABATE CHASES ONLY FROM FINISHED FLOOR OF 1ST FLOOR TO ROOF.

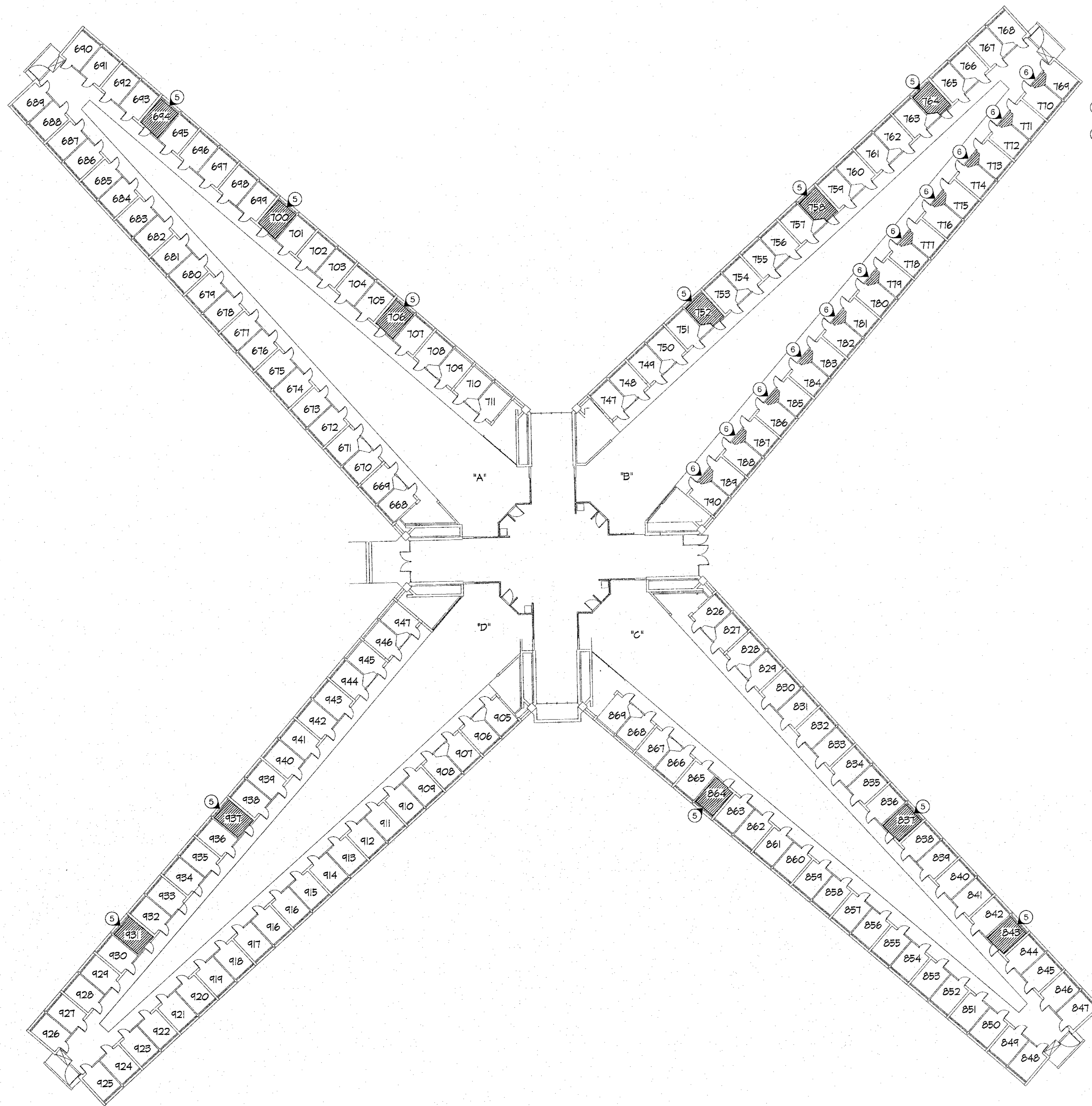

1 HOUSING UNIT 3 UPPER LEVEL ASBESTOS REMEDIATION AREAS
SCALE: 1/16"=1'-0"



3100 Brown Station Rd. Suite C
Columbia, MO. 65202
(573) 875-0045 Phone
(573) 875-0046 FAX
WWW.MOENGINEERING.COM
Midwest Engineering & Design
Missouri State Certificate of Authority #2010032457

OFFICE OF ADMINISTRATION
DIVISION OF FACILITIES
MANAGEMENT,
DESIGN AND CONSTRUCTION

MISSOURI DEPARTMENT
OF CORRECTIONS

ABATE AND REPLACE
PIPING VARIOUS

MOBERLY CORRECTIONAL
CENTER
5201 S. MORLEY STREET
MOBERLY, MO

PROJECT # C1601-01
SITE # 2305
FACILITY # 27250/27265

REVISION: _____
DATE: _____
REVISION: _____
DATE: _____
REVISION: _____
DATE: _____
ISSUE DATE: 11/06/2017

CAD DWG FILE: MCC-h.dwg
DRAWN BY: CJH/MDS/JDK
CHECKED BY: JLD
DESIGNED BY: CJH

SHEET TITLE:
**HOUSING UNIT 3
ASBESTOS
REMEDATION AREAS**

SHEET NUMBER:

H-104