

Architecture
Interior Design
Planning
Sustainability
2801 Woodard Drive, Suite 103
Columbia, MO 65202
573.443.1407
www.soa-inc.com
Missouri Certificate of
Authority Number: 000826

MEP ENGINEER
2801 Woodard Drive, Suite 105
Columbia, MO 65202
573.443.1407
STRUCTURAL ENGINEER

McCLURE
ENGINEERING, P.C.
1901 Pennsylvania Dr,
Columbia, MO 65202
573.814.1568
MO COA No. E-2006023253
Exp. December, 31 2018

City of Columbia Parks and Recreation Department
Clary Shy Agriculture Park
1751, 1769, & 1857 WEST ASH ST
COLUMBIA, MO 65203

ISSUE FOR PERMIT	
October 19, 2017	
REVISION	DATE

DETAILS

C0.50

SOA PROJECT 16052

If you must print this drawing, please recycle

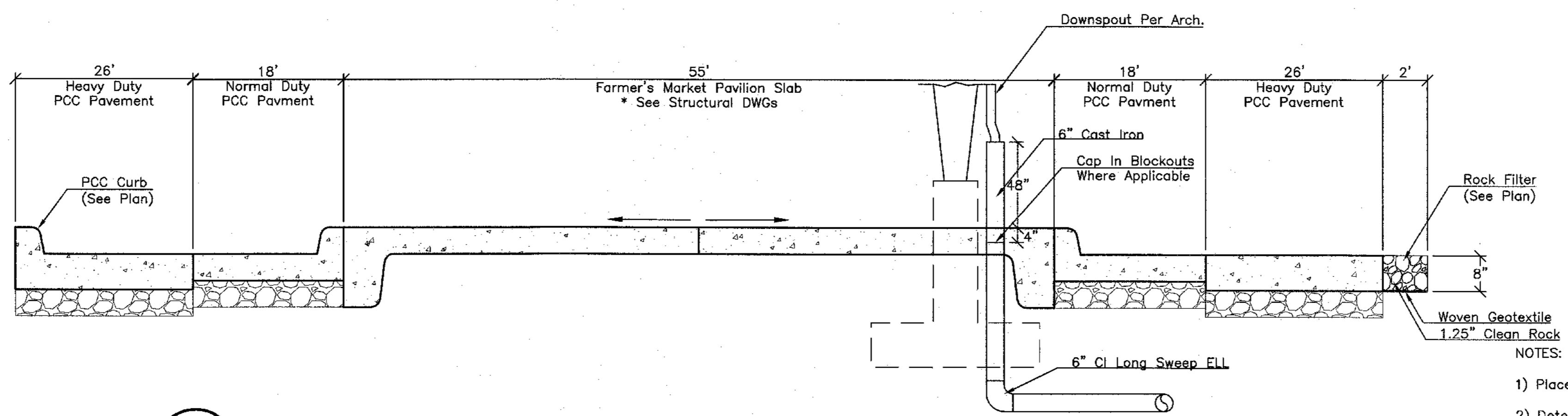

6 FARMER'S MARKET PAVILION TYPICAL PAVEMENT SECTION - PAVILION
N.T.S.

1 NORMAL DUTY PCC PAVEMENT
C0.50

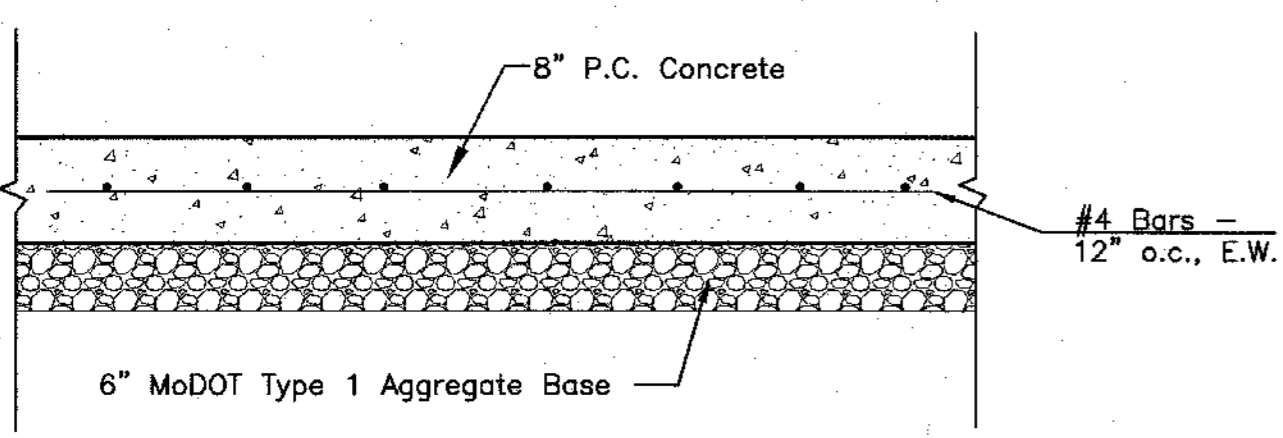

2 HEAVY DUTY PCC PAVEMENT
C0.50

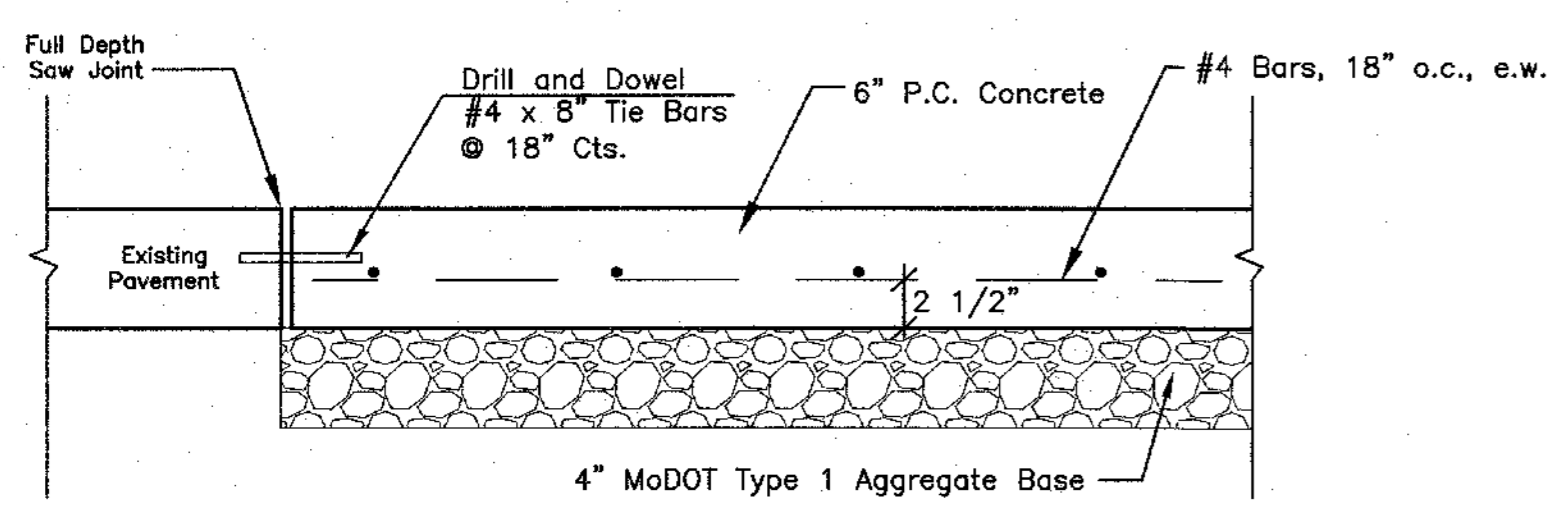

3 P.C.C. PAVEMENT PATCH
C0.50

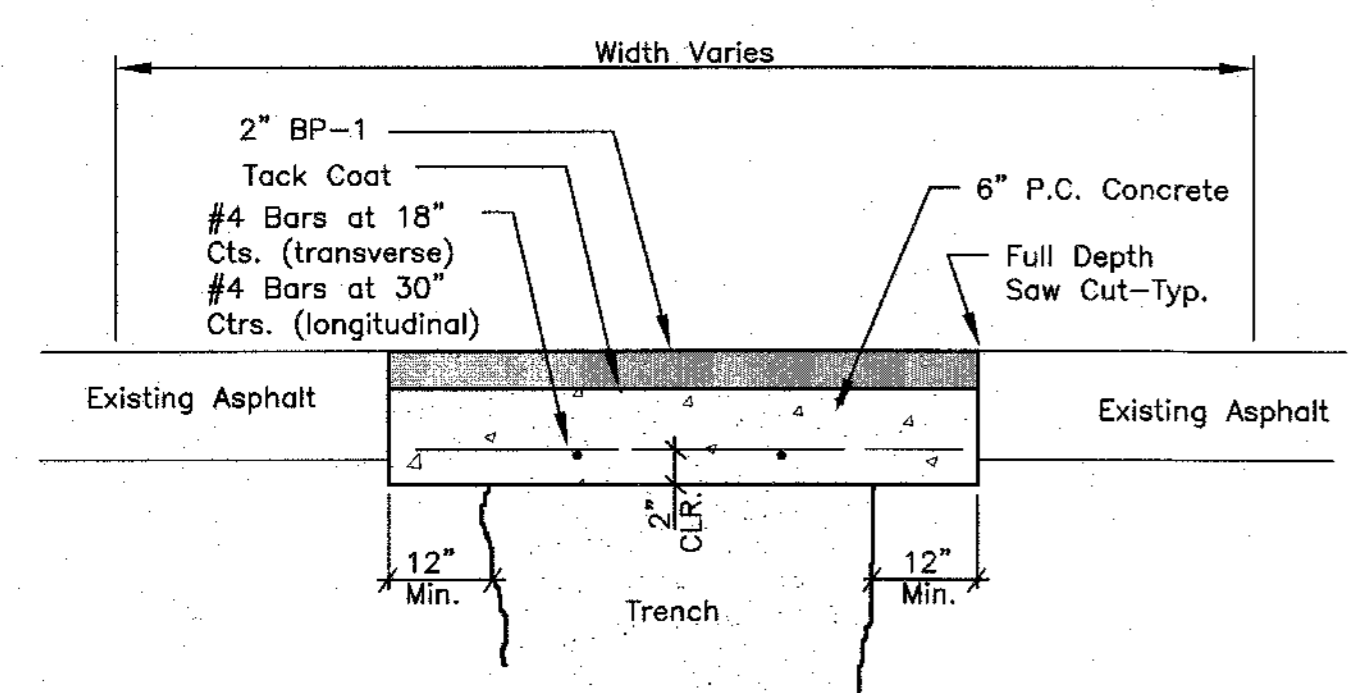

4 ASPHALT PAVEMENT PATCH - TRENCH
C0.50

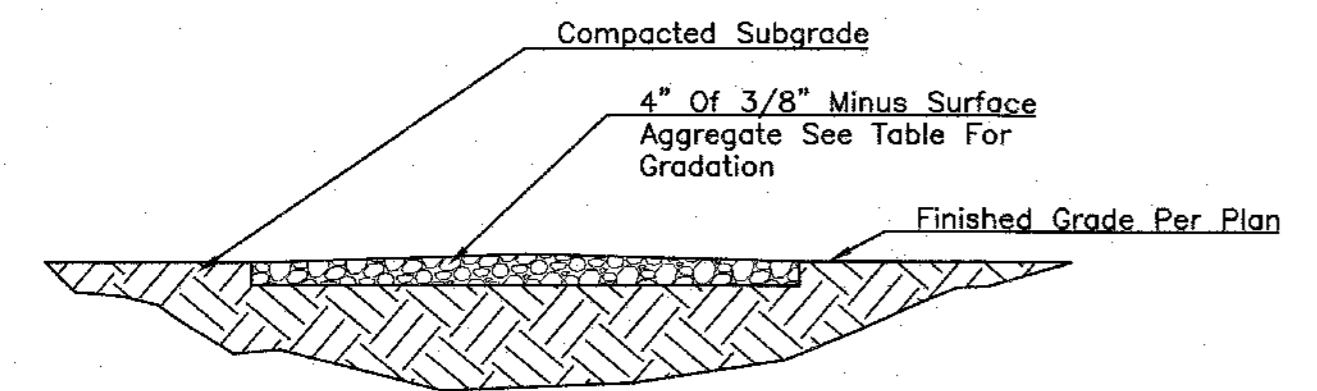

Sieve Size	% Passing
1/2"	100%
3/8"	98%
#4	75% - 85%
#8	55% - 65%
#16	30% - 50%
#30	30% - 35%
#200	20%

5 TRAIL SURFACING
C0.50 N.T.S.

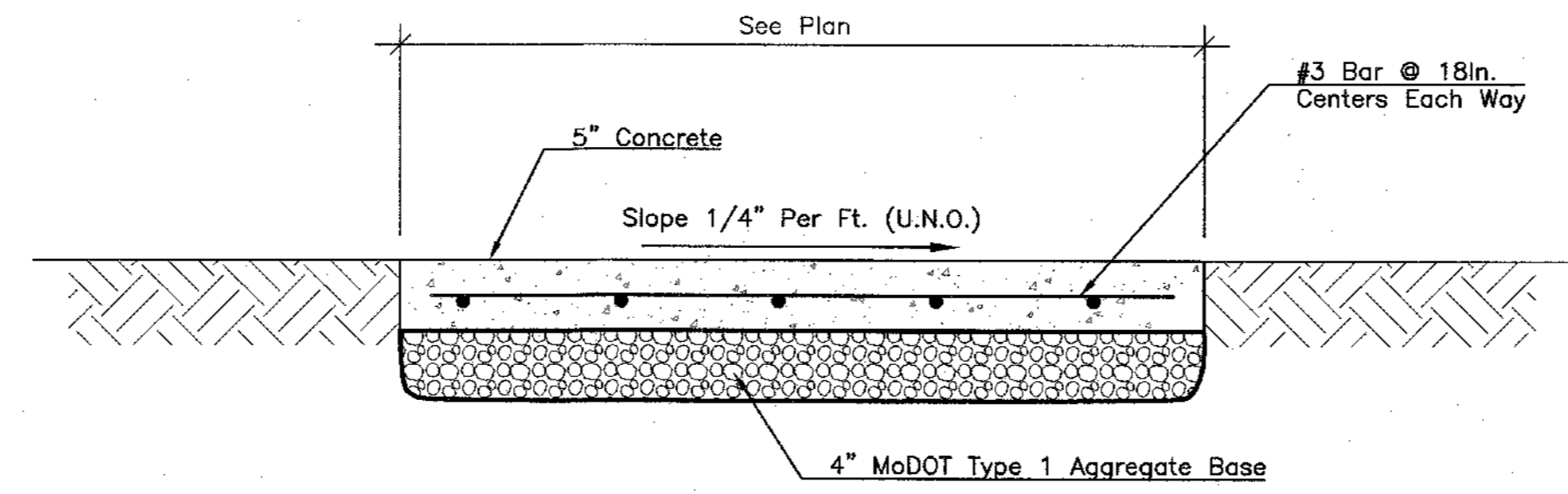

7 PCC SIDEWALK
N.T.S.

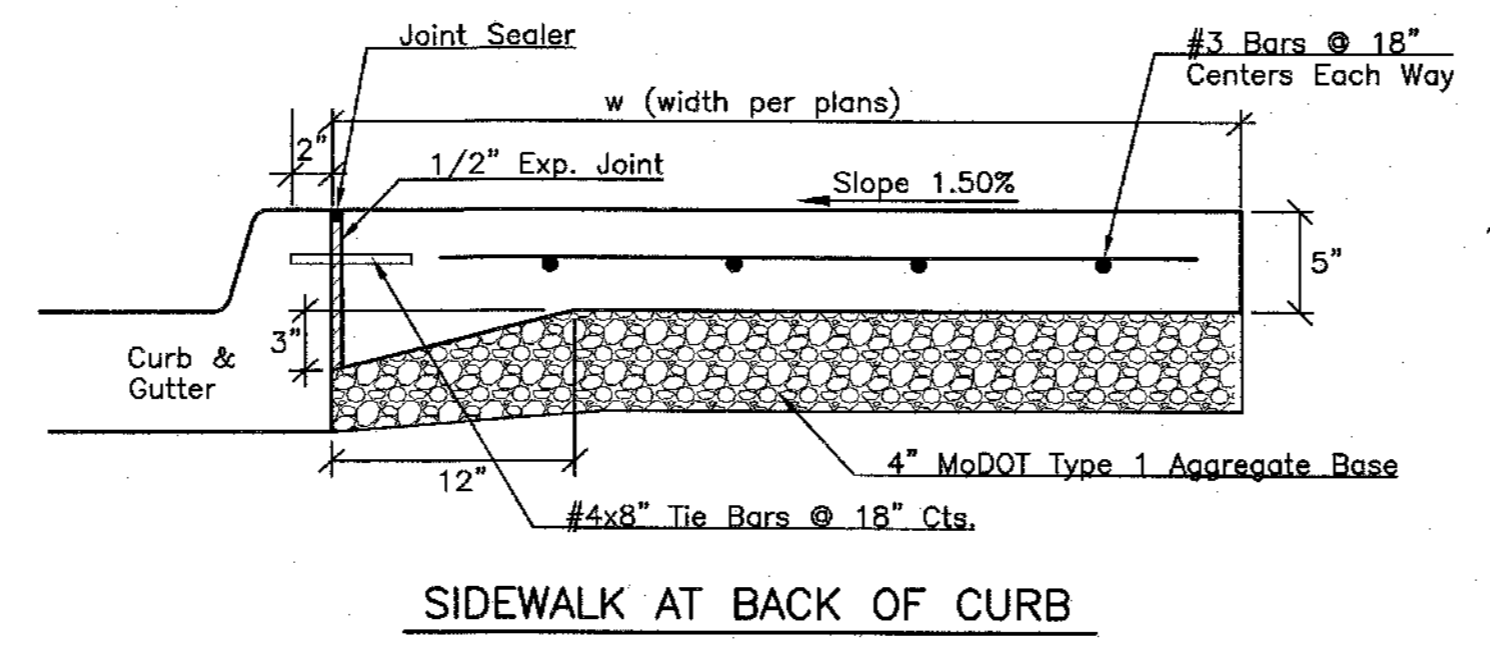

8 PCC CURB & GUTTER
N.T.S.

- NOTES:
- All P.C. concrete shall be f'c = 4000 psi.
 - Install 1/2" expansion joints in curb and gutter section at P.C. and P.T. of curb radius of intersections and every 150'.
 - Install saw joints in curb and gutter section at 10 ft. maximum spacing. Seal with bitumastic joint sealant.
 - 4% parabolic crown is acceptable in lieu of 2% normal crown.
 - Contractor shall only use this detail for work within City of Columbia Right of Way.

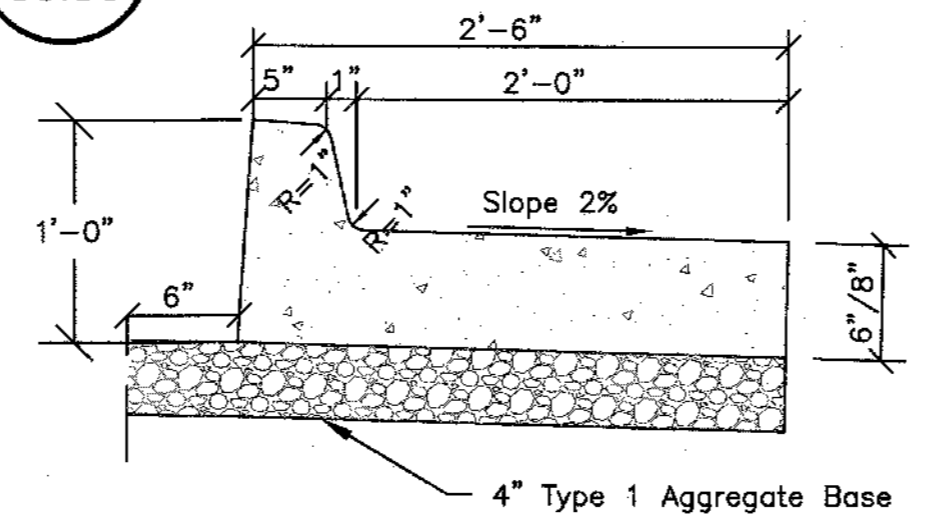

9 REVERSE SLOPE PCC CURB
N.T.S.

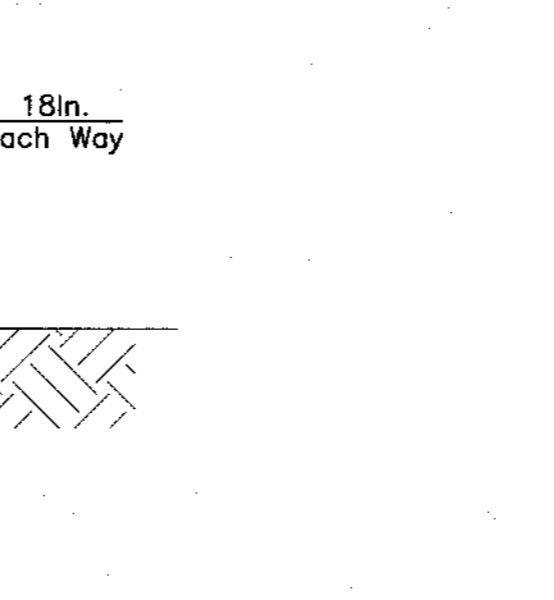

10 DETECTABLE WARNING
C0.50 N.T.S.

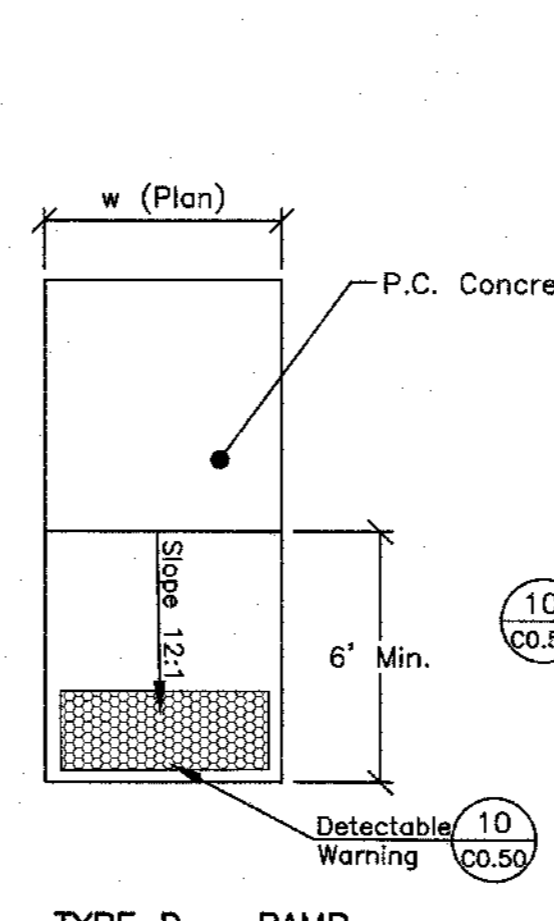

11 SIDEWALK ACCESSIBLE RAMP
C0.50 N.T.S.

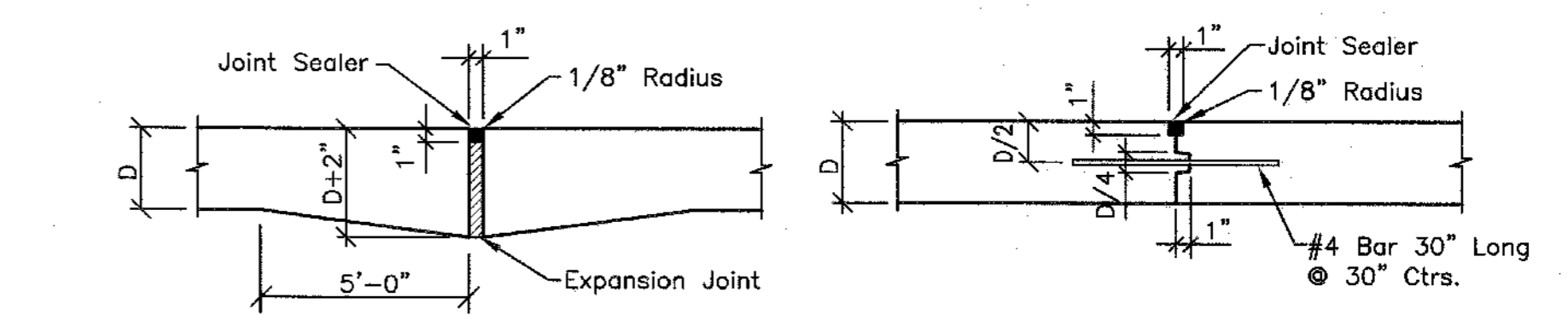

12 JOINT DETAILS
C0.50 N.T.S.

- NOTES:
- Place detectable warnings at locations shown on plans and details.
 - Detectable warning tiles shall be ADA compliant; measure 2' deep min., and cover the width of sidewalk. Color = red. Acceptable products are "Duratek" by Detectile Corporation, "Replaceable Cast in Place" by Armor-Tile Tactile Systems, or Approved Equal. Install in accordance with manufacturer's instructions.

- Notes:
- * For Ramp with Parkway, Mirror 0'-2' Transition - Same as Other Side of Walk.

- TYPE (B) - CONSTRUCTED WITHOUT TIE BAR
TYPE (BS) - REQUIRES TIE BAR

- TYPE (C) - CONSTRUCTED WITHOUT TIE BAR
TYPE (CS) - REQUIRES TIE BAR

- TYPE (C & CS) SAWED OR PREMOLD STRIP