

- ROOF PLAN KEYED NOTES**
- NOTE: NOT ALL KEYED NOTES MAY APPEAR ON EACH DRAWING
- 1 BATTEN-SEAM METAL ROOF
 - 2 METAL RIDGE CAP - REFER TO A1/A-531 FOR ALTERNATE, D5/A-535 FOR BASE BID
 - 3 CRICKET
 - 4 VENT THROUGH BATTEN-SEAM METAL ROOF - REFER TO PLUMBING / MECHANICAL DRAWINGS AND BOOT DETAILS B3/A-531 AND B4/A-531
 - 5 RIDGE FLASHING - REFER TO B1/513
 - 6 ROOFTOP FALL ARREST SYSTEM - REFER TO A3/A-533 FOR APPLICATION ON PVC MEMBRANE ROOF - REFER TO A2/A-533 FOR APPLICATION ON BATTEN-SEAM METAL ROOF
 - 7 SNOW GUARD - REFER TO C1/A-531 FOR PVC MEMBRANE ROOF AND C2/A-531 FOR BATTEN-SEAM METAL ROOF
 - 8 MANUFACTURED CANOPY, BELOW - FOR DETAIL REFER TO C2/A-511
 - 9 CANOPY, BELOW - FOR PLAN REFER TO A1/A-401
 - 10 ANTENNAE SUPPORT RAIL - REFER TO B3/A-533 FOR ROOF PENETRATION DETAILS AT PVC ROOFING - REFER TO STRUCTURAL / TELECOM FOR ANTENNAE RAIL DETAILS
 - 11 ROOF HATCH - FOR PLAN REFER TO A4/A-531
 - 12 MANUFACTURED ROOF EXPANSION JOINT - REFER TO D3/A-533
 - 13 BUILT-IN GUTTER - REFER TO C1/A-534
 - 14 PVC MEMBRANE ROOF
 - 15 WALKWAYS - REFER TO D2/A-533
 - 16 VENT THROUGH PVC MEMBRANE ROOF - REFER TO C4/A-531 FOR APPLICATION OF PVC ROOFING, AND C3/A-531 FOR APPLICATION OF BATTEN-SEAM METAL ROOFING
 - 17 5" X 6" STAINLESS STEEL DOWNSPOUT TO CAST IRON DOWNSPOUT BOOT AT GRADE - REFER TO D5/A-534
 - 18 ROOF DRAIN AND OVERFLOW DRAIN - REFER TO B4/A-533
 - 19 SHEET METAL COPING
 - 20 TAPERED INSULATION / SADDLE
 - 21 EQUIPMENT ON PREFABRICATED ROOF CURB - REFER TO MECHANICAL FOR DETAIL OF CURB REFER TO C2/A-533
 - 22 BUILT-IN GUTTER - REFER TO C2/A-535
 - 23 ANTENNAE SUPPORT RAIL - REFER TO A3/A-535 FOR ROOF PENETRATION DETAILS AT BATTEN-SEAM METAL ROOF - REFER TO STRUCTURAL / TELECOM FOR ANTENNAE RAIL DETAILS
 - 24 MANUFACTURED ROOF EXPANSION JOINT - REFER TO A5/A-535
 - 25 MECHANICAL EQUIPMENT ON MANUFACTURED ROOF CURB - REFER TO B4/A-534 (SIMILAR)
 - 26 EXPANSION JOINT IN RIDGE FLASHING - REFER TO B2/A-535

JACOBS
 501 North Broadway, Saint Louis, Missouri 63102
 TEL: 314.335.4000
 JACOBS ENGINEERING GROUP, INC.
 Missouri State Certificate of Authority #002704
 Consultant - Civil
 MILLENNIA PROFESSIONAL SERVICES OF ILLINOIS, LTD.
 11 Executive Drive, Suite 12
 Fairview Heights, Illinois, 62208
 Tel: 618-624-8610
 Missouri State Certificate of Authority #2012009247

Robert A. Messel, AIA
 Architect
 MO# A-3930

| REV | DESCRIPTION | DATE |
|-----|-------------|------|
| | | |
| | | |
| | | |

AVCRAD PHASE 3A ADDITION
 1107th THEATER AVIATION SUSTAINMENT MAINTENANCE GROUP

MISSOURI ARMY NATIONAL GUARD
 GREENE COUNTY
 SPRINGFIELD, MISSOURI
 CONTRACT NO. T1808-01

NATIONAL GUARD BUREAU
 NGB PROJECT NO. 290109

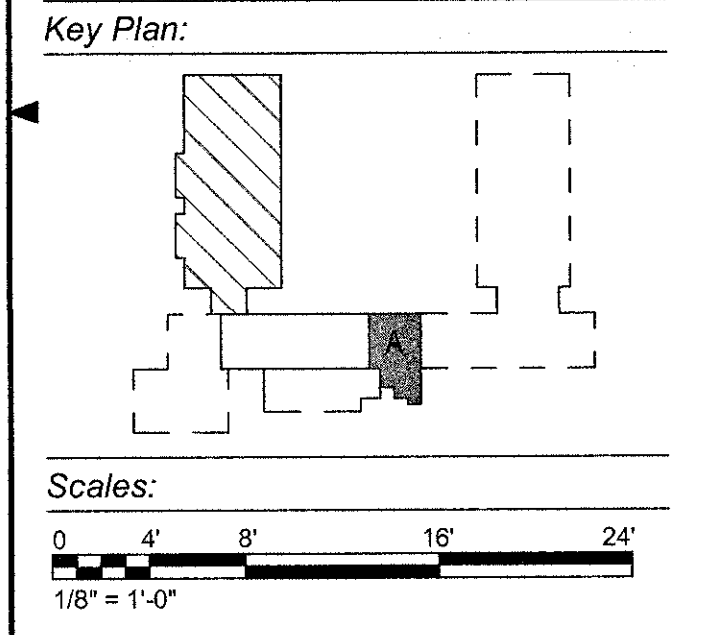

Project No.: T1808-01
 Drawing Title: ARCHITECTURAL PARTIAL ROOF PLAN - AREA A - (ALTERNATE)
 Date: 29 JUNE 2018
 Designed: AT
 Drawn: NF
 Checked: RY
 Drawing No.: **A-136**
 121 of 322

JACOBS PROJECT NO. F3W91001
 7/30/2018 11:57:41 AM BIM_360/105-F3W91000-TASMG-ARCH-HIMORING TASMG-ARCH-V17.rvt

A1 PARTIAL ROOF PLAN - AREA A
 1/8" = 1'-0"