

Jeffrey A. Huettnermeyer
PE-2001019755

CENTRAL MISSOURI PROFESSIONAL SERVICES, INC.
CIVIL ENGINEER
MISSOURI STATE CERTIFICATE OF AUTHORITY #
SSC ENGINEERING, INC.
MECHANICAL/ELECTRICAL/PLUMBING ENGINEER
MISSOURI STATE CERTIFICATE OF AUTHORITY #007244
SSC ENGINEERING, INC.
REGISTERED PROFESSIONAL ENGINEER
MISSOURI STATE CERTIFICATE OF AUTHORITY #001244

The Architects Alliance inc.
Missouri State Certificate of Authority # 000143
631 West Main Street
Jefferson City, Missouri
(573) 636-5000 phone

ELECTRICAL LIGHTING PLAN

MISSOURI SOYBEAN INNOVATION CENTER
NEW OFFICE BUILDING
734 S. COUNTRY CLUB DRIVE
JEFFERSON CITY, MISSOURI

PROJECT NO. 1613
DATE: Sept. 12, 2018

E1.1

ELECTRICAL GENERAL NOTES:

- REFER TO SHEET ED.1 FOR SYMBOLS, ABBREVIATIONS AND GENERAL CONSTRUCTION NOTES.
 - REFER TO THE ELECTRICAL DETAILS SHEETS FOR LIGHTING CONTROL SCHEMATIC.
 - SUSPENDED CEILING SYSTEMS ARE DESIGNED TO SUPPORT THE WEIGHT OF ALL LIGHTING FIXTURES. THE STRUCTURAL FRAMING SHALL SUPPORT ALL CONDUITS, JUNCTION BOXES, ETC ABOVE CEILING.
 - EMERGENCY LIGHTING SHALL BE SWITCHED AND NOT BE USED AS A NIGHT LIGHT. CONNECT EMERGENCY BALLAST VOLTAGE SENSING LEADS AHEAD OF SWITCH LEG OR OTHER CONTROL DEVICE TO CIRCUIT INDICATED.
 - LIGHTING CONTROLS SYSTEM BASIS OF DESIGN IS OSRAM. CONTACT SCOTT ANDERSON AT WARD AND BURTON FOR ANY QUESTIONS REGARDING THE OSRAM SYSTEM. PHONE: 314-821-7800, E-MAIL: SCOTT@WARDANDBURTON.COM.
 - ROUTE ALL OVERHEAD CONDUIT TIGHT TO UNDERSIDE OF ROOF DECK OR TRUSSES. CONDUITS SHALL RUN PARALLEL OR PERPENDICULAR TO BUILDING STRUCTURE.
- PROVIDE WIRELESS 2-BUTTON SWITCH/DIMMER.
 - PROVIDE WIRELESS PIR OCCUPANCY SENSOR (SCPPH) WITH COVERAGE AREA AS REQUIRED.
 - PROVIDE WIRED WALL SWITCH BOX PIR OCCUPANCY SENSOR WITH OVER-RIDE SWITCH (PW-100-24).
 - PROVIDE WIRELESS 2-BUTTON SWITCH/DIMMER.
 - PROVIDE WIRELESS 3-SCENE CONTROLLER.
 - PROVIDE WIRED, LOW-VOLTAGE, OUTDOOR PHOTO SENSOR CONNECTED TO LIGHTING CONTROL SYSTEM.
 - PROVIDE WIRELESS 3-ZONE CONTROLLER.
 - PROVIDE FIXTURE WITH 20 DEGREE SLOPED CEILING ADAPTOR, COORDINATE EXACT ANGLE WITH ARCHITECTURAL PLANS.

ELECTRICAL KEYED NOTES:

- OSRAM WIRELESS AREA LIGHTING CONTROLLER. (WALC)
- OSRAM WIRELESS CONTROL MODULE. (WCM)
- PHASE CUT DIMMING MODULE - FORWARD AND REVERSE PHASE DIMMING. CONNECT TO AREA LIGHTING CONTROLLER.
- PHASE CUT DIMMING MODULE TETHERED TO WIRELESS CONTROL MODULE WITH GREENBUS CABLE.
- PROVIDE PENDANT MOUNTED EXIT SIGN. PENDANT SHALL BE SWIVEL MOUNTED, WHITE, OF LENGTH AS REQUIRED SO BOTTOM OF EXIT SIGN IS 9' AFF.
- CONTROL EF WITH LIGHTS THROUGH WALL BOX OCCUPANCY SENSOR.
- GANG MULTIPLE REMOTE TEST SWITCHES FOR EMERGENCY DRIVERS SERVING MEETING/TRAINING ROOM 106, CATERING 105, CORRIDOR, SOY DISPLAY 101, VESTIBULE 100, AND MAIN ENTRY EXTERIOR. MAXIMUM DISTANCE BETWEEN DRIVER AND TEST SWITCH IS 100 FEET.
- PROVIDE EMERGENCY BATTERY DRIVER WITH SELF-TEST AND REMOTE TEST SWITCH EQUIVALENT TO BOONE BSL 310 PIST. INSTALL IN AN ACCESSIBLE BUT INCONSPICUOUS LOCATION. CONNECT SWITCHED AND UNSWITCHED CIRCUITS FROM BRANCH CIRCUIT INDICATED.
- GANG MULTIPLE REMOTE TEST SWITCHES FOR EMERGENCY DRIVERS SERVING TYPES C,F, AND G FIXTURES IN CORRIDOR 116, CORRIDOR 118 AND CONFERENCE 114. MAX DISTANCE BETWEEN DRIVER AND TEST SWITCH IS 100 FEET.
- GANG MULTIPLE REMOTE TEST SWITCHES FOR EMERGENCY DRIVERS SERVING TYPES G AND H FIXTURES IN LOBBY 107, MEZZANINE, CORRIDORS 142, 143, AND STAIR. MAX DISTANCE BETWEEN DRIVER AND TEST SWITCH IS 100 FEET.
- GANG MULTIPLE REMOTE TEST SWITCHES FOR EMERGENCY DRIVERS SERVING TYPES G,H, AND E FIXTURES IN CORRIDORS 128, 133, FILES 137 AND OPEN OFFICE 126.

ELECTRICAL MEZZANINE PLAN SCALE: 1/8" = 1'-0" NORTH

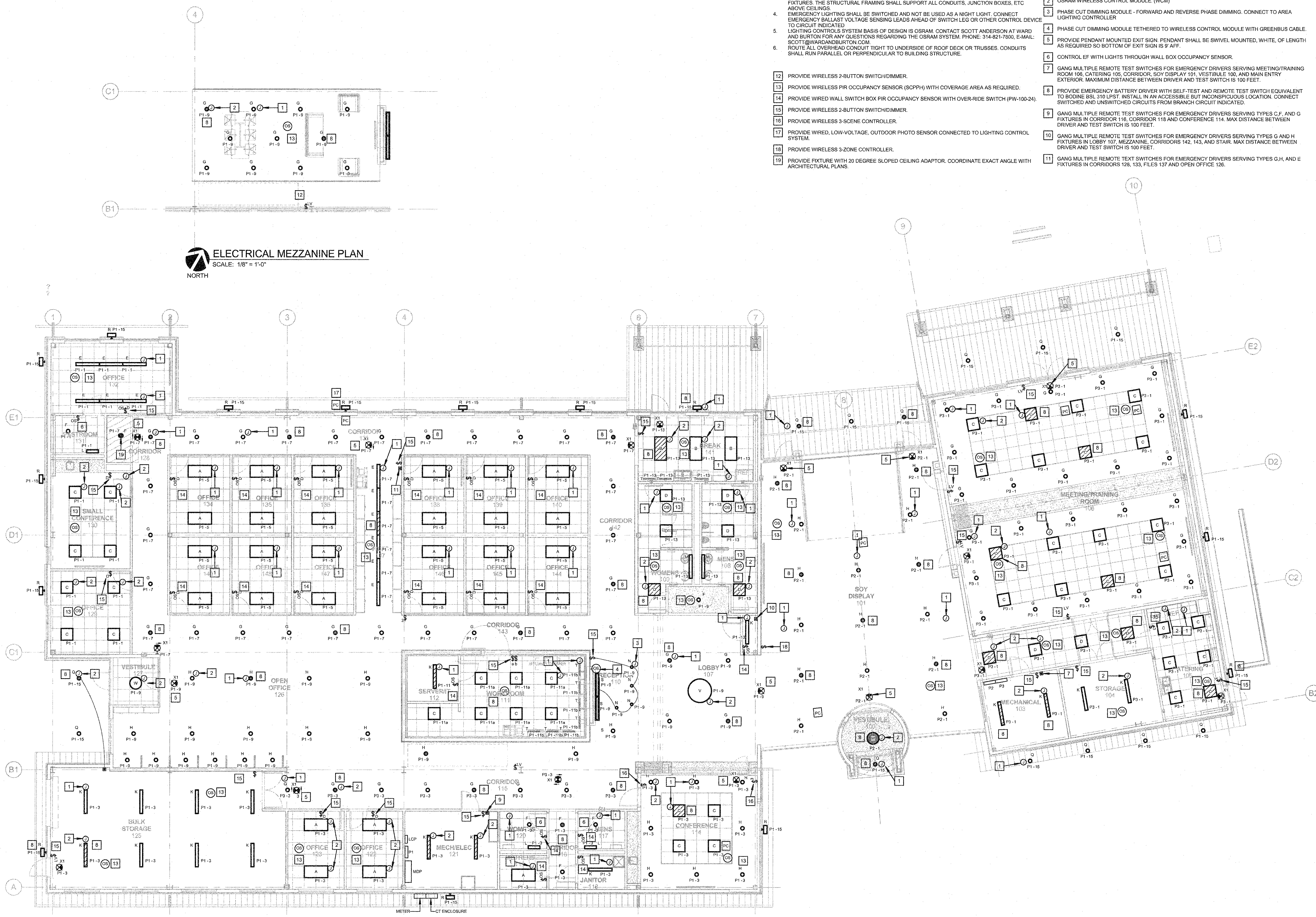

ELECTRICAL LIGHTING PLAN SCALE: 1/8" = 1'-0" NORTH

The Bid and Contract Documents, including Addenda, shall be read in conjunction with the Drawings to which they are attached. Responsibility for all other Plans, Specifications, Estimates, and other documents shall be the responsibility of the Architect. This drawing is intended to be used for any part or parts of the project. Copyright © 2018 by SSC Engineering, Inc.

2017349 - BID/PERMIT SET - 09-12-18