

Jeffrey A. Huettnermeyer
PE-2001018755

CENTRAL MISSOURI PROFESSIONAL SERVICES, INC.
MISSOURI STATE CERTIFICATE OF AUTHORITY #

SSC ENGINEERING, INC.
MISSOURI STATE CERTIFICATE OF AUTHORITY #001244

SSC ENGINEERING, INC.
MISSOURI STATE CERTIFICATE OF AUTHORITY #001244



Missouri State Certificate of Authority # 000143
631 West Main Street
Jefferson City, Missouri
(573) 636-5000 phone

ELECTRICAL
EQUIPMENT PLAN

MISSOURI SOYBEAN INNOVATION CENTER
NEW OFFICE BUILDING
734 S. COUNTRY CLUB DRIVE
JEFFERSON CITY, MISSOURI

PROJECT NO. 1613
DATE: Sept. 12, 2018

E4.1

ELECTRICAL GENERAL NOTES:

1. REFER TO SHEET E0.1 FOR SYMBOLS, ABBREVIATIONS AND GENERAL CONSTRUCTION NOTES.
2. ALL MECHANICAL, ELECTRICAL, PLUMBING, FIRE PROTECTION, AND HVAC WORK SHALL BE COORDINATED BY THE CONTRACTOR DOING THE WORK. ANY CORRECTIONS TO ANY OF THE ABOVE SHALL BE AT THAT CONTRACTOR'S EXPENSE.
3. ALL DISCONNECTS REQUIRED SHALL BE PROVIDED BY THE EC. U.N.O. SEE MECHANICAL & PLUMBING EQUIPMENT SCHEDULES FOR EQUIPMENT DETAILS AND FOR DISCONNECTS FURNISHED BY OTHERS. REFER TO MANUFACTURER'S SPECIFICATIONS FOR MECHANICAL & PLUMBING EQUIPMENT CONNECTION DETAILS. COORDINATE WITH APPLICABLE TRADES.
4. PROVIDE EQUIPMENT GROUNDING CONDUCTOR IN ALL FEEDERS, SIZED IN ACCORDANCE WITH NEC ARTICLE 250.122. SEE SPECIFICATIONS.
5. ALL EXTERIOR ELECTRICAL EQUIPMENT AND DISCONNECT SWITCHES SHALL BE IN RATED NEMA 3R OR 4X ENCLOSURES. FINAL CONDUIT CONNECTIONS TO MECHANICAL EQUIPMENT SHALL BE MADE WITH LFMC. ROUTE ALL OVERHEAD CONDUIT TIGHT TO UNDERSIDE OF ROOF DECK OR TRUSSES. CONDUITS SHALL RUN PARALLEL OR PERPENDICULAR TO BUILDING STRUCTURE.

ELECTRICAL KEYED NOTES:

- 1 FUSED DISCONNECT SWITCH PER MANUFACTURER. PROVIDE 15A FUSE.
- 2 CONTROL EF FROM WALL BOX OCCUPANCY SENSOR WITH LIGHTING. INTERCONNECT LIGHTING AND EXHAUST FAN TO SAME CIRCUIT SWITCHLEG.

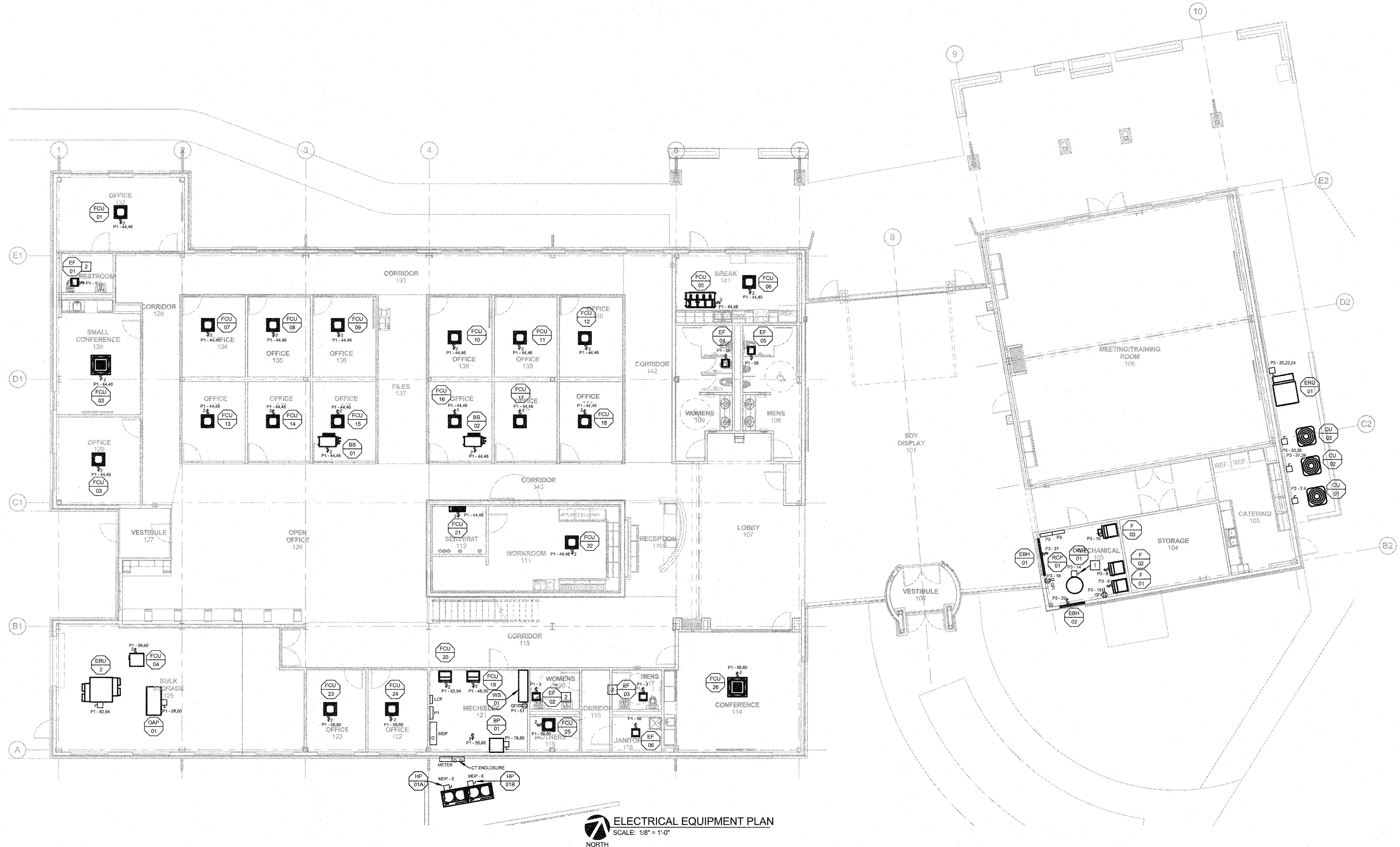

ELECTRICAL EQUIPMENT PLAN
SCALE: 1/8" = 1'-0"
NORTH

The Bid and Contract documents refer to the Documents to which they are attached, and Excessively Disclaim any Responsibility for all other Plans, Specifications, Estimates, intended to be used for any part or parts of the work. Copyright © 2018 by SSC Engineering, Inc.

2017349 - BID/PERMIT SET - 09-12-18