

ELECTRICAL KEYED NOTES:

- 1 LOCATION OF DATA/VV RACK TO BE PROVIDED BY OWNERS VENDOR. COORDINATE LOCATION AND REQUIREMENTS.
- 2 PROVIDE LEGRAND RFB8E-0G FLOOR BOX OR EQUIVALENT. THIS IS TYPICAL OF ALL FLOOR BOXES.
- 3 PROVIDE CONDUIT FOR ANY CONNECTIONS BETWEEN TV AND WALL AND FLOOR BOXES.
- 4 TMGB GROUND BUS WITH #4 AWG TO MDP GROUND SYSTEM.
- 5 STUB OUT NEAR CORNER OF PARKING LOT. 4" C FOR FUTURE PV POWER.
- 6 STUB OUT NEAR CORNER OF PARKING LOT. 2" C FOR FUTURE PV CONTROLS.
- 7 MOTOR FOR OVERHEAD DOOR.
- 8 PUSHBUTTONS TO OPERATE OVERHEAD DOOR.
- 9 CONNECTION FOR ELECTRICAL FIREPLACE.
- 10 FIBER SHALL BE RUN FROM HERE TO THE RACK IN STORAGE 104. PROVIDE 1-1/2" C WITH PULL TAPE.
- 11 COORDINATE EXACT LOCATION OF RECESSED FLOOR BOX TO BE BELOW TABLE.
- 12 PROVIDE TWO TV BOXES AT THIS LOCATION, ONE AT +40" AFF AND ONE AT +66" AFF. SEE ARCH ELEVATIONS FOR MORE INFORMATION.
- 13 SNAP SWITCH FOR FIREPLACE. MOUNT +46" AFF.
- 14 CONNECTION FOR UNDER CABINET HOOD. MOUNT +78" AFF.
- 15 PROVIDE 4"W X 8"H X 3/4" FRIT PLYWOOD PAINTED WITH FRIT PAINT ON ALL FACES AND EDGES (EXCEPT FRIT STAMP) ON 3 WALLS OF SERVER IT 112 AS INDICATED.

ELECTRICAL GENERAL NOTES:

- 1 REFER TO SHEET E0.1 FOR SYMBOLS, ABBREVIATIONS AND GENERAL CONSTRUCTION NOTES.
- 2 ALL MECHANICAL, ELECTRICAL, PLUMBING, FIRE PROTECTION, AND HVAC WORK SHALL BE COORDINATED BY THE CONTRACTOR DOING THE WORK. ANY CORRECTIONS TO ANY OF THE ABOVE SHALL BE AT THE CONTRACTOR'S EXPENSE.
- 3 ALL DISCONNECTS REQUIRED SHALL BE PROVIDED BY THE EC, U.N.O. SEE MECHANICAL & PLUMBING EQUIPMENT SCHEDULE(S) FOR EQUIPMENT DETAILS AND FOR DISCONNECTS FURNISHED BY OTHERS. REFER TO MANUFACTURER'S SPECIFICATIONS FOR MECHANICAL & PLUMBING EQUIPMENT CONNECTION DETAILS. COORDINATE WITH APPLICABLE TRADES.
- 4 PROVIDE EQUIPMENT GROUNDING CONDUCTOR IN ALL FEEDERS, SIZED IN ACCORDANCE WITH NEC ARTICLE 250-122. SEE SPECIFICATIONS.
- 5 ALL EXTERIOR ELECTRICAL EQUIPMENT AND DISCONNECT SWITCHES SHALL BE IN RATED NEMA 3R OR 4X ENCLOSURES. FINAL CONDUIT CONNECTIONS TO MECHANICAL EQUIPMENT SHALL BE MADE WITH LPMC. REFER TO ELECTRICAL DETAILS SHEET(S) AND OWNERS VENDOR FOR ADDITIONAL PHONE AND DATA ROUGH-IN REQUIREMENTS.
- 6 CONTRACTOR SHALL COORDINATE THE EXACT LOCATION OF ALL FLOOR BOXES AND POKE THROUGH WITH STRUCTURAL PLANS AND ARCHITECT PRIOR TO INSTALLATION. LOCATION SHALL BE COORDINATED TO AVOID STRUCTURAL ELEMENTS AND MATCH FURNITURE LOCATIONS.
- 7 ROUTE ALL OVERHEAD CONDUIT TIGHT TO UNDERSIDE OF ROOF DECK OR TRUSSES. CONDUITS SHALL RUN PARALLEL OR PERPENDICULAR TO BUILDING STRUCTURE.
- 8 OWNER HAS CONTRACTED WITH A SEPARATE LOW VOLTAGE CONTRACTOR OUTSIDE OF THIS CONTRACT FOR VOICE/DATA, AV, BURGLAR ALARM, ACCESS CONTROL, VIDEO SURVEILLANCE & INTERCOM SYSTEMS.

09/12/18

CENTRAL MISSOURI PROFESSIONAL SERVICES, INC.
 CIVIL ENGINEER
 MISSOURI STATE CERTIFICATE OF AUTHORITY #
 SSC ENGINEERS, INC.
 MECHANICAL/ELECTRICAL/PLUMBING ENGINEER
 MISSOURI STATE CERTIFICATE OF AUTHORITY #001244
 SSC ENGINEERING, INC.
 ELECTRICAL ENGINEER
 MISSOURI STATE CERTIFICATE OF AUTHORITY #001244

The Architects Alliance inc.
 Missouri State Certificate of Authority # 000143
 631 West Main Street
 Jefferson City, Missouri
 (573) 636-5000 phone

ELECTRICAL POWER, VOICE & DATA PLAN

MISSOURI SOYBEAN INNOVATION CENTER
 NEW OFFICE BUILDING
 734 S. COUNTRY CLUB DRIVE
 JEFFERSON CITY, MISSOURI

PROJECT NO. 1613
 DATE: Sept. 12, 2018

E2.1

ELECTRICAL PARTIAL PLATFORM POWER, DATA, & VOICE PLAN
 SCALE: 1/8" = 1'-0"
 NORTH

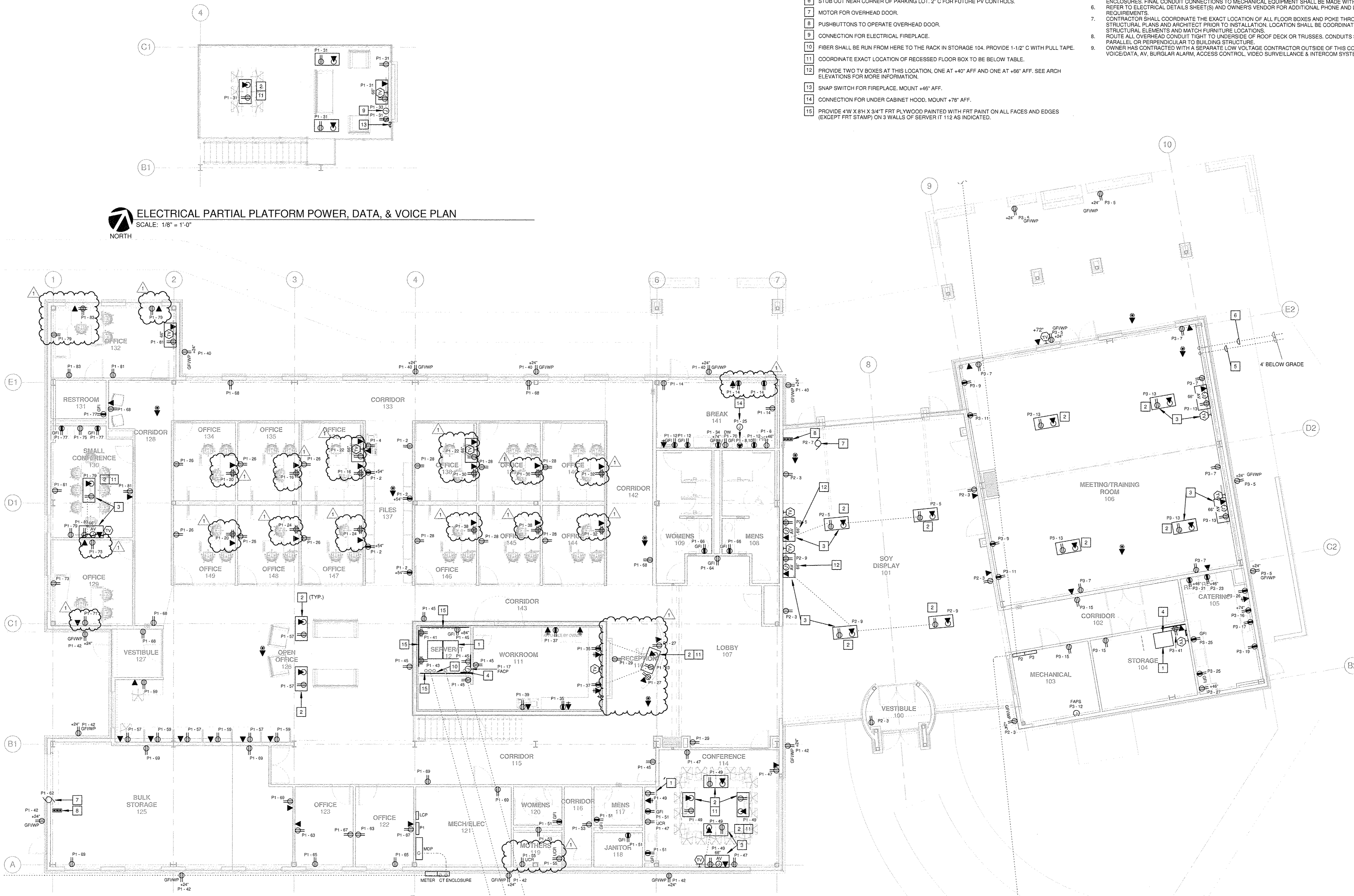

The Seal and Signature apply only to the Document to which they are Affixed, and Electronic Decision any Reason, or other Document or instrument, including for or Copyright © 2018 by SSC Engineering, Inc.

ELECTRICAL POWER, DATA, & VOICE PLAN
 SCALE: 1/8" = 1'-0"
 NORTH

2017349 - BID/PERMIT SET - 09-12-18