

EL DORADO DR. STORMWATER SITE PLAN NOTES:

- ① REMOVE EXISTING TREE OR BUSH (TYP.). GRIND OR REMOVE STUMP A MINIMUM OF 6" BELOW FINISHED GRADE.
- ② DO NOT DISTURB EXISTING BUSHES, TREES, OR GRASSES.
- ③ EXCAVATE, REMOVE, AND DISPOSE OF EXISTING STORMWATER PIPES AND INLETS.
- ④ MAKE FULL DEPTH SAW CUT AND REMOVE EXISTING CONCRETE PAVEMENT. TYPE OF PAVEMENT PATCH WILL DICTATE LOCATION OF SAW CUT AND QUANTITY OF PAVEMENT TO BE REMOVED. SEE "PAVEMENT PATCH DETAILS."
- ⑤ EXISTING WATER SERVICE SHALL BE RELOCATED. CONTRACTOR SHALL BE RESPONSIBLE FOR COORDINATING WITH WATER DISTRICT.
- ⑥ CONSTRUCT PROPOSED STORMWATER SYSTEM PER ALL PLANS, PROFILES, DETAILS, AND SPECIAL PROVISIONS.
- ⑦ INSTALL APPROPRIATE PAVEMENT PATCH AS PER "PAVEMENT PATCH DETAILS."
- ⑧ INSTALL RIP RAP ROCK BLANKET WITH MINIMUM THICKNESS OF 1.50 FEET. RIP RAP SHALL BE 6X9 ROCK. SLOPES FOR ROCK BLANKETS SHALL NOT EXCEED 1.5:1'. NON-WOVEN GEOTEXTILE, GEOTEX 801 OR APPROVED EQUAL, SHALL BE INSTALLED BETWEEN THE SUBGRADE AND ROCK BLANKET. CONTRACTOR SHALL USE EXISTING ROCK IN DISTURBED AREAS FOR THE PROPOSED ROCK BLANKET WHEN POSSIBLE.
- ⑨ BRING ALL DISTURBED AREAS TO FINISHED GRADE WITH 4" OF TOP SOIL. DISTURBED AREAS SHALL BE RESTORED WITH SEED, FERTILIZER, AND EROSION CONTROL BLANKET (LANDLOK S2 OR APPROVED EQUAL). JOINTS IN EROSION CONTROL BLANKET SHALL BE OVERLAPPED A MINIMUM OF 6" AND SECURED USING LANDSCAPING STAPLES. AREAS BETWEEN JOINTS SHALL ALSO BE SECURED WITH STAPLES, WITH SPACING PER BLANKET MANUFACTURER'S RECOMMENDATION.
- ⑩ PORTIONS OF EXISTING SPLIT RAIL FENCE WILL BE REMOVED BY OTHERS PRIOR TO CONSTRUCTION.

EL DORADO STORMWATER CONTROL POINTS			
POINT #	NORTHING	EASTING	ELEV.
11	1127450.3403	1703585.6220	741.632
2767	1127459.7766	1703533.3842	737.446
2769	1127482.8797	1703455.5770	722.859

EL DORADO STORMWATER POINTS			
POINT #	NORTHING	EASTING	ELEV.
E1	1127428.6105	1703608.6042	741.85
E2	1127422.8326	1703606.9867	741.85
F1	1127440.8732	1703575.3062	741.77
F2	1127436.0886	1703573.8544	741.77
G1	1127461.7417	1703521.9380	735.00
G2	1127457.0836	1703520.1209	735.00
H1	1127490.0743	1703449.3093	721.44
H2	1127485.4163	1703447.4922	721.44
DF	1127491.8663	1703437.8369	713.40

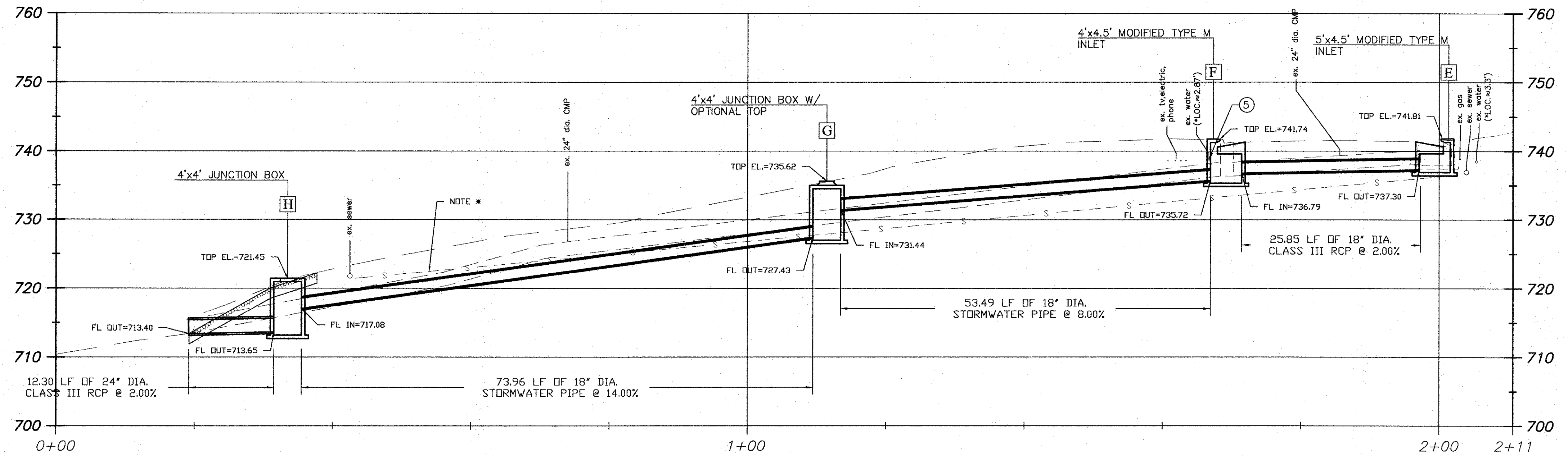

PROFILE VIEW: EL DORADO STORM CL

NOTE * - SANITARY SEWER IS SHOWN ON THE PROFILE VIEW AS A REMINDER A SEWER MAIN IS LOCATED IN CLOSE PROXIMITY AND RUNNING PARALLEL TO PROPOSED WORK.

STREET REHAB - 2019
EL CHAPARRAL SUBDIVISION
EL DORADO STORMWATER PLAN

Boone County Resource Management Department
Engineering Division
 801 E. Walnut, Room 315
 Columbia, Missouri 65201
 Phone: 572-888-4480
 Fax: 572-888-5940

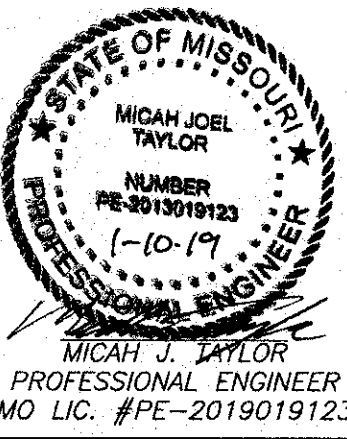
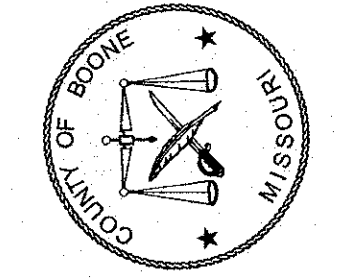

REVISIONS	
DATE	DATE

DATE
JAN. 2019

JOB NUMBER

SCALE
1"=10'

SHEET
6
6 OF 24